

APPENDIX B

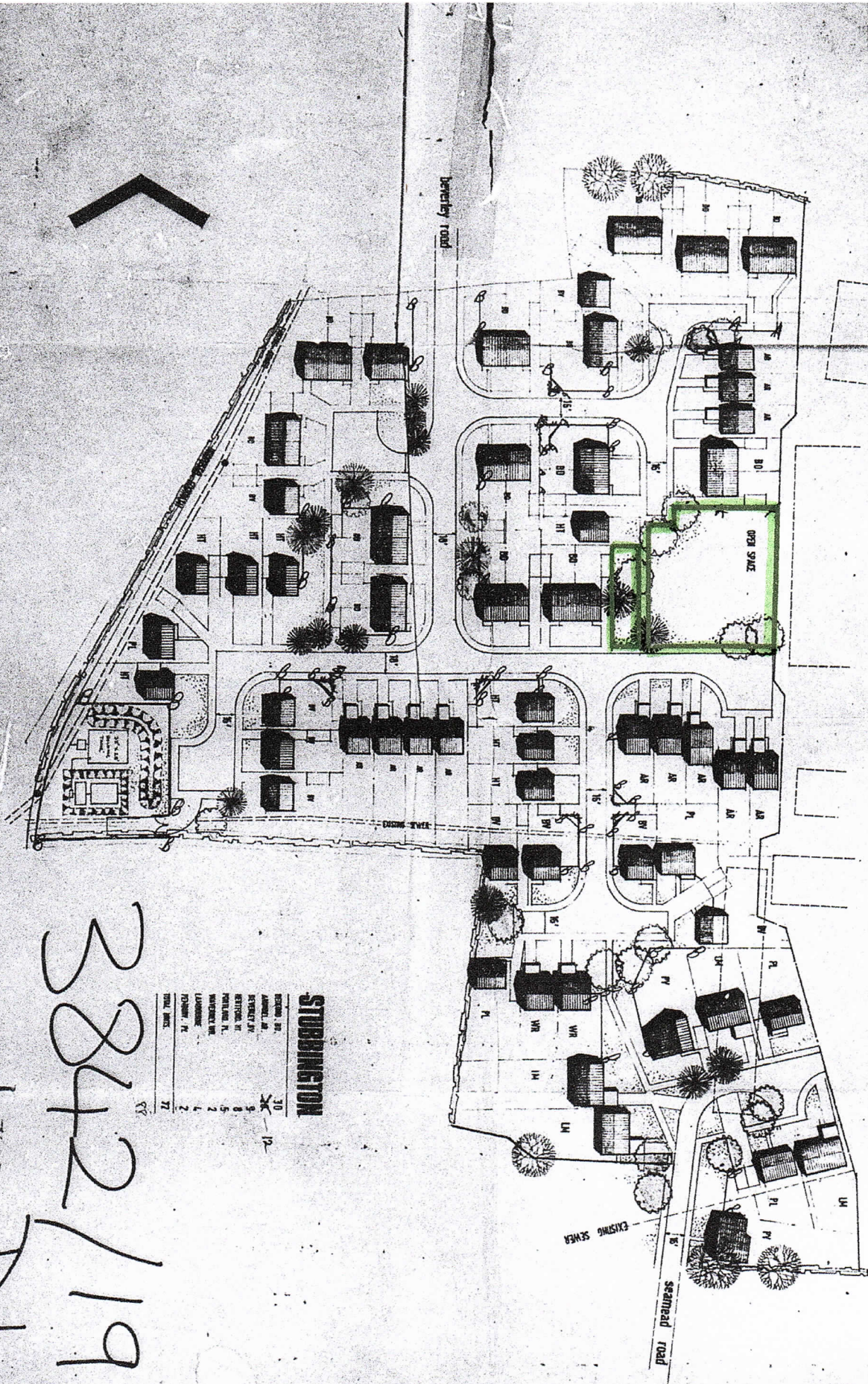

STUBBINGTON

STUBBINGTON	30	12
APPROX. AC.	9	
RETIRED AC.	8	
RETIRED AC.	5	
RETIRED AC.	2	
RETIRED AC.	2	
RETIRED AC.	4	
RETIRED AC.	2	
TOTAL AC.	27	62

3842/19
D1